

PREPARING AND STORING

Over 50 years of fabrication

From standard one-offs to full kitchen fabrication schemes - Corsair has the answer with our comprehensive range of options, plus dishwasher tabling for all dishwashers.

DERWENT WALL AND CENTRE TABLES

Derwent Wall Benches

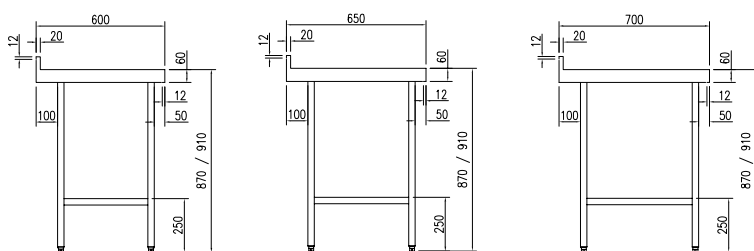

Series 600

Series 650

Series 700

Length	Model No.	Model No.	Model No.
600mm	CHP6006WB	CHP6506WB	CHP7006WB
900mm	CHP6009WB	CHP6509WB	CHP7009WB
1000mm	CHP6010WB	CHP6510WB	CHP7010WB
1200mm	CHP6012WB	CHP6512WB	CHP7012WB
1500mm	CHP6015WB	CHP6515WB	CHP7015WB
1800mm	CHP6018WB	CHP6518WB	CHP7018WB
2100mm	CHP6021WB	CHP6521WB	CHP7021WB
2400mm	CHP6024WB	CHP6524WB	CHP7024WB
2700mm	CHP6027WB	CHP6527WB	CHP7027WB
3000mm	CHP6030WB	CHP6530WB	CHP7030WB



Corsair's renowned Derwent Wall Benches are supplied in standard depths of 600mm, 650mm and 700mm and suite perfectly with the extensive range of Derwent Sink units. With industry-leading specifications, Derwent Tables easily meet the needs of the most demanding commercial catering establishments.

- 600/650/700mm Range
- 1.5mm 304 stainless worktops
- 1.2mm 430 stainless undershelf
- Sound-deadening pads
- Undershelf supplied as standard on all models
- All models despatched fully assembled or welded (non-standard sizes)
- Wall Benches have 60mm upstands and downturns
- Centre Tables with 60mm downturn
- Height adjustment 870/ 910mm

Derwent Centre Tables

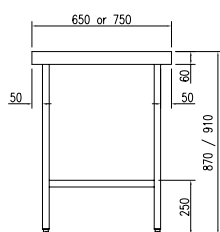

Series 650

Series 750

Length	Model No.	Model No.
600mm	CHP6506CT	CHP7506CT
900mm	CHP6509CT	CHP7509CT
1000mm	CHP6510CT	CHP7510CT
1200mm	CHP6512CT	CHP7512CT
1500mm	CHP6515CT	CHP7515CT
1800mm	CHP6518CT	CHP7518CT
2100mm	CHP6521CT	CHP7521CT
2400mm	CHP6524CT	CHP7524CT
2700mm	CHP6527CT	CHP7527CT
3000mm	CHP6530CT	CHP7530CT



Material specification as per Derwent Wall Benches. Centre tables are either 650mm deep or 750mm deep x 870/910mm high.